

RATCHETING CRIMPER



SKU # 43159

Provides the Perfect Crimp Every Time!

FEATURES:

- Crimps gauges from 22 gauge through 10 gauge.
- Ratcheting action provides ease of use and forms a perfect double crimp on each connector.
- Eliminates damaged or distorted terminals.
- Crimpers will not release until crimp is fully formed.
- Crimp is flat all of the way across the crimp and does not cut or roll the wire to the side
- Superior design and construction outperforms everything else on the market
- Color coded crimp allows for exact matchup to terminal size every time.

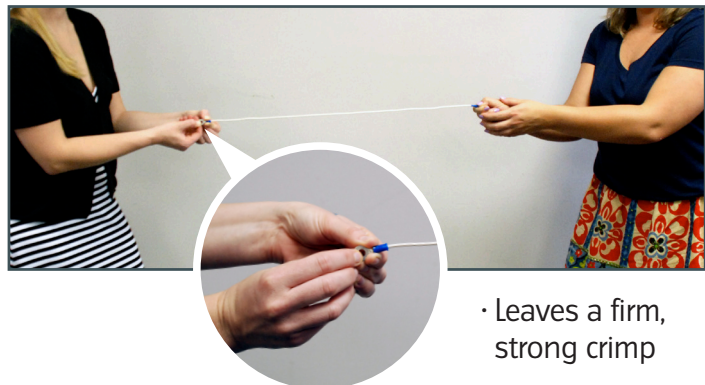

- Leaves a firm, strong crimp

DCT DURABLE COMPONENT TECH
1-800-285-7965
P.O. BOX 15204, ST. LOUIS, MO 63110